

GLEASON **PowerTrak**[®] **GRP**

Mini-GRP

Non-Metallic Cable/Hose Carrier

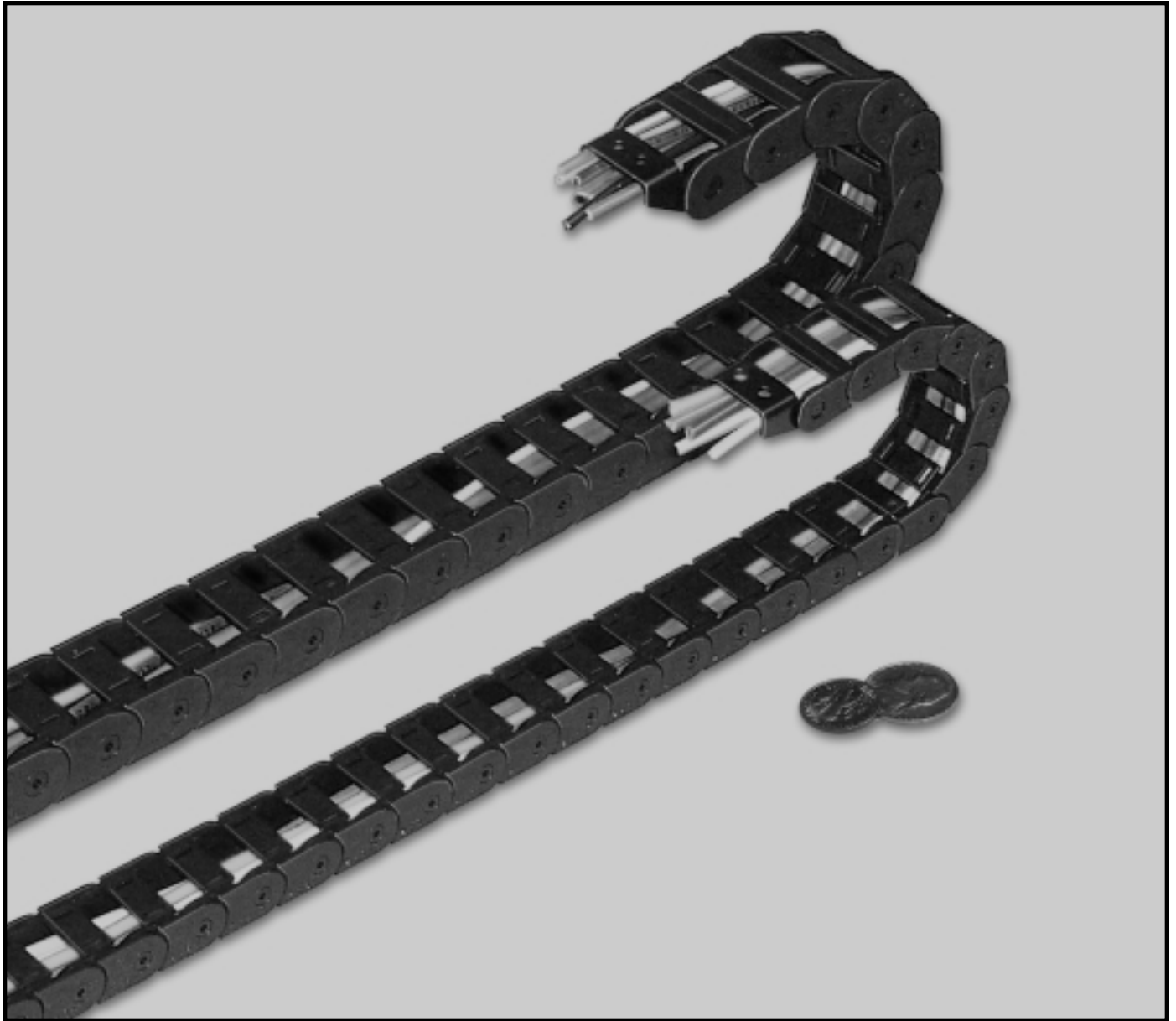

POWERTRAK MODELS 049P and 071P

PTMG0701

GLEASON® PowerTrak^{GRP}

049P-1, 2 & 3

- IDEAL FOR SMALL, HIGH-SPEED APPLICATIONS
- SNAP-TOGETHER LINKS WITH **FLIP-TOPS**
- RADII "A" AVAILABLE= 0.71", 1.10", 1.46" (18, 28, 37)
PT049P-2 also available with 2.75" (70mm)
- MAX CABLE/HOSE O.D. = 0.31 IN.(8mm)
- TOTAL TRAVEL–SELF SUPPORTED, NO SAG = 3.0 ft.(0.9m)^①
- TOTAL TRAVEL–SELF SUPPORTED, W/SAG = 4.0 ft.(1.2m)^①
- MAX SPEED = 197 in./sec.(5000mm/sec)
- MAX ACCELERATION = 1158 in./sec² (29400mm/sec²)
- UNLOADED WEIGHT: 049P-1 = 0.07 LBS/FT.(0.10kg/m)
- UNLOADED WEIGHT: 049P-2 & 3 = 0.08 LBS/FT.(0.12kg/m)

Dimensions in inches (mm) unless otherwise indicated.

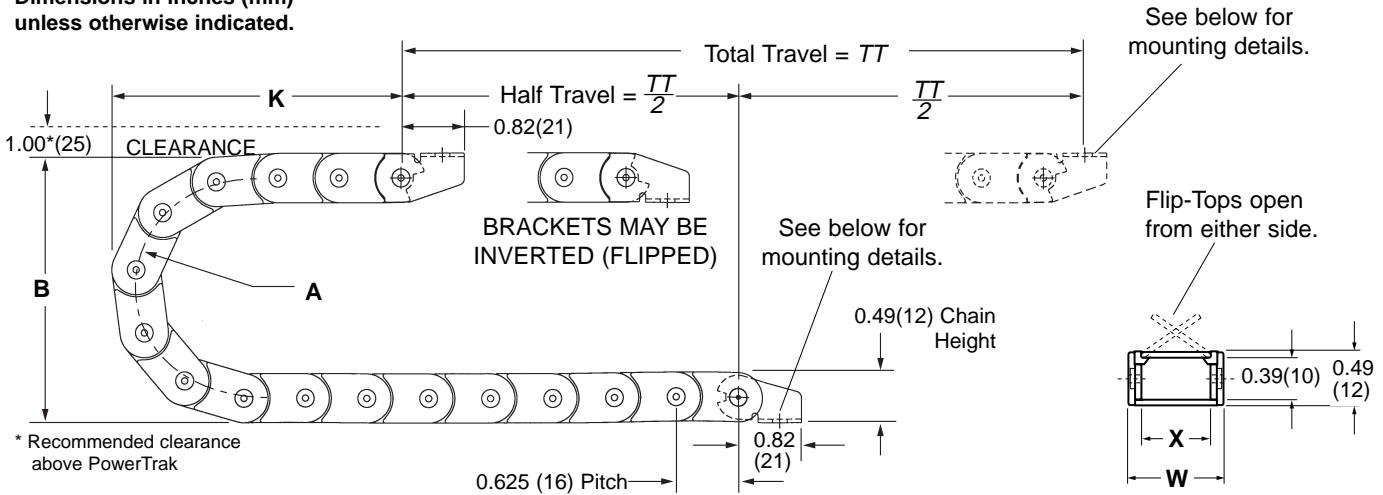

* Recommended clearance above PowerTrak

Standard Travel
Required length (ft) ^② = $\frac{TT}{2} + L$ ^④

End Feed
Required length (ft) ^③ = $TT + L$ ^④

MODEL No.	RADIUS A	HEIGHT B	MIN. K	CURVE L ^④	OPENING X	WIDTH W
049P-1-0.7	0.71 (18)	1.91 (49)	1.64 (42)	0.3 ft. (0.09m)	0.39 (10)	0.63 (16)
049P-1-1.1	1.10 (28)	2.69 (68)	2.02 (51)	0.4 ft. (0.12m)	0.39 (10)	0.63 (16)
049P-1-1.4	1.46 (37)	3.41 (87)	2.41 (61)	0.5 ft. (0.15m)	0.39 (10)	0.63 (16)
049P-2-0.7	0.71 (18)	1.91 (49)	1.64 (42)	0.3 ft. (0.09m)	0.63 (16)	0.87 (22)
049P-2-1.1	1.10 (28)	2.69 (68)	2.02 (51)	0.4 ft. (0.12m)	0.63 (16)	0.87 (22)
049P-2-1.4	1.46 (37)	3.41 (87)	2.41 (61)	0.5 ft. (0.15m)	0.63 (16)	0.87 (22)
049P-2-2.7	2.75 (70)	5.99 (152)	4.07 (104)	0.9 ft. (0.27m)	0.63 (16)	0.87 (22)
049P-3-0.7	0.71 (18)	1.91 (49)	1.64 (42)	0.3 ft. (0.09m)	0.79 (20)	1.03 (26)
049P-3-1.1	1.10 (28)	2.69 (68)	2.02 (51)	0.4 ft. (0.12m)	0.79 (20)	1.03 (26)
049P-3-1.4	1.46 (37)	3.41 (87)	2.41 (61)	0.5 ft. (0.15m)	0.79 (20)	1.03 (26)

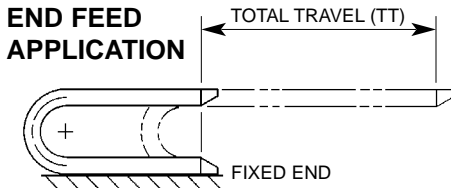

NOTES:

- ① Based on standard travel with a cable/hose package weight of 0.20 lbs/ft.(0.3kg/m)
- ② Based on standard travel, i.e. two-way payout as pictured above.
- ③ Based on End Feed application. See diagram, left.
- ④ Minimum length in FEET required to form PowerTrak curve.

MOUNTING DETAILS

MALE BRACKET

Usually used on fixed end.

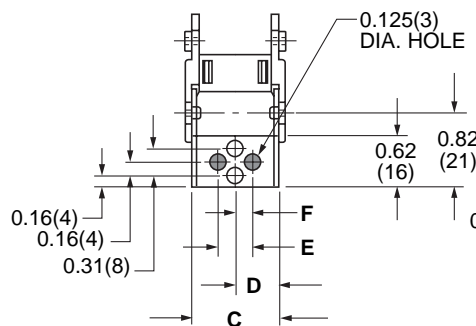

FEMALE BRACKET

Usually used on moving end.

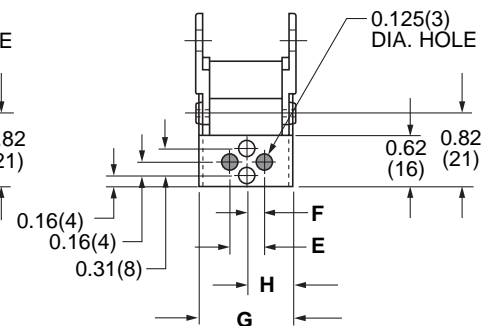

BRACKET KITS*

MODEL	049P-1	049P-2	049P-3
KIT NO.	BK049-1	BK049-2	BK049-3
Dim. C	0.51(13)	0.75(19)	0.91(23)
Dim. D	0.25(6)	0.38(10)	0.46(12)
Dim. E	na**	0.31(8)	0.44(11)
Dim. F	na**	0.16(4)	0.22(6)
Dim. G	0.58(15)	0.82(21)	0.98(25)
Dim. H	0.29(7)	0.41(10)	0.49(12)

*Each kit contains one male and one female bracket.

**049P-1 has two mounting holes in center of bracket, shown in white on drawings above. All four holes used on 049P-2 & 049P-3 only.

GLEASON® PowerTrak_{GRP}

071P-1&2

- IDEAL FOR SMALL, HIGH-SPEED APPLICATIONS
- SNAP-TOGETHER LINKS WITH **FLIP-TOPS**
- RADII "A" AVAILABLE= 1.10", 1.46", 1.97"
(28, 37, 50mm)
- MAX CABLE/HOSE O.D. = 0.49 IN.(12mm)
- TOTAL TRAVEL—SELF SUPPORTED, NO SAG = 4.0 ft.(1.2m)^①
- TOTAL TRAVEL—SELF SUPPORTED, W/SAG = 5.0 ft.(1.5m)^①
- MAX SPEED = 197 in./sec.(5000mm/sec)
- MAX ACCELERATION = 1158 in./sec² (29400mm/sec²)
- UNLOADED WEIGHT: 071P-1= 0.14 LBS/FT.(0.21kg/m)
- UNLOADED WEIGHT: 071P-2= 0.15 LBS/FT.(0.22kg/m)

Dimensions in inches (mm) unless otherwise indicated.

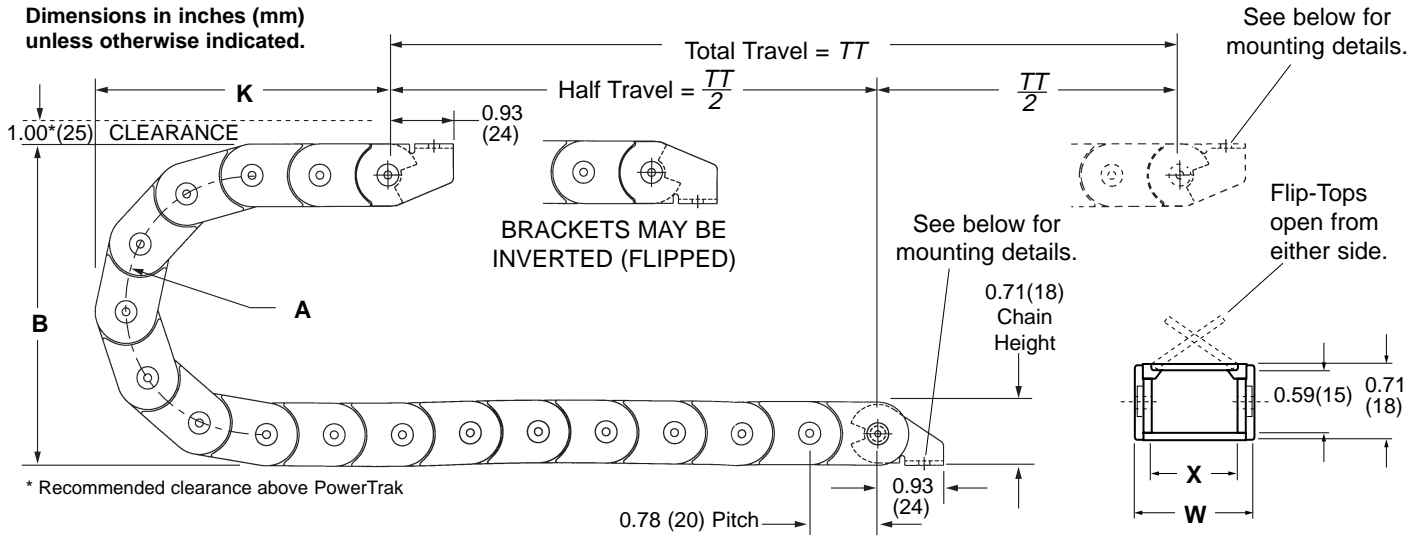

Standard Travel
Required length (ft) ^② = $\frac{TT}{2} + L$ ^④

End Feed
Required length (ft) ^③ = $TT + L$ ^④

MODEL NUMBERS	RADIUS A	HEIGHT B	MIN. K	CURVE L ^④	OPENING X	WIDTH W
071P-1-1.1	1.10 (28)	2.91 (74)	2.13 (54)	0.4 ft. (0.12m)	0.79 (20)	1.10 (28)
071P-1-1.4	1.46 (37)	3.63 (92)	2.52 (64)	0.5 ft. (0.15m)	0.79 (20)	1.10 (28)
071P-1-1.9	1.97 (50)	4.65 (118)	3.43 (87)	0.7 ft. (0.21m)	0.79 (20)	1.10 (28)
071P-2-1.1	1.10 (28)	2.91 (74)	2.13 (54)	0.4 ft. (0.12m)	1.18 (30)	1.49 (38)
071P-2-1.4	1.46 (37)	3.63 (92)	2.52 (64)	0.5 ft. (0.15m)	1.18 (30)	1.49 (38)
071P-2-1.9	1.97 (50)	4.65 (118)	3.43 (87)	0.7 ft. (0.21m)	1.18 (30)	1.49 (38)

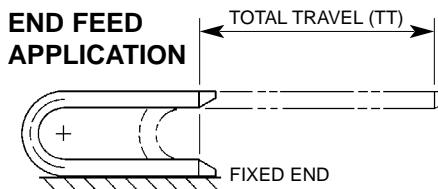

MOVABLE END

NOTES:

- ① Based on standard travel with a cable/hose package weight of 0.30 lbs/ft.(0.45kg/m)
- ② Based on standard travel, i.e. two-way payout as pictured above.
- ③ Based on End Feed application. See diagram, left.
- ④ Minimum length in FEET required to form PowerTrak curve.

MOUNTING DETAILS

BRACKET KITS*

MODEL	071P-1	071P-2
KIT NO.	BK071-1	BK071-2
Dim. C	0.95(24)	1.33(34)
Dim. D	0.32(8)	0.24(6)
Dim. E	0.31(8)	0.86(22)
Dim. F	0.16(4)	0.43(11)
Dim. G	1.04(26)	1.44(37)
Dim. H	0.37(9)	0.29(7)

*Each kit contains one male and one female bracket.

MALE BRACKET

Usually used on fixed end.

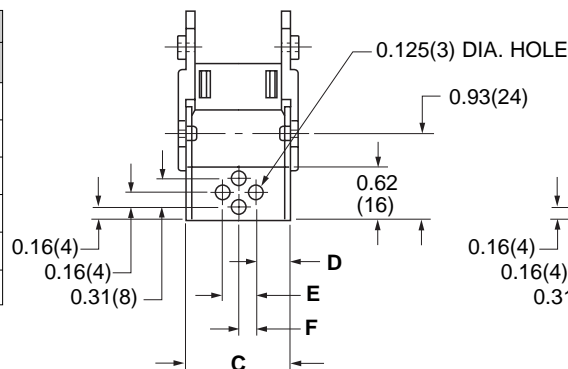

FEMALE BRACKET

Usually used on moving end.

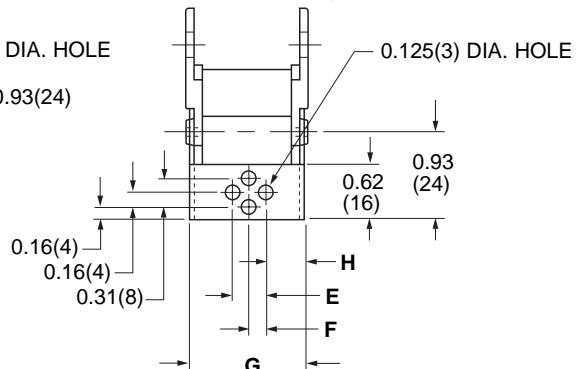

FLIP-TOP simplifies cable loading.

- Open from either side using a pocket screwdriver.
- Snap shut after cable is installed.

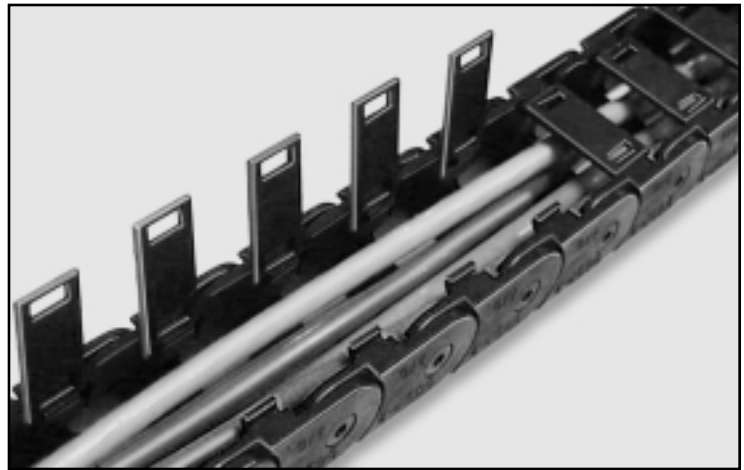

APPLICATION

STANDARD TRAVEL

- Two-way payout
- Typically center-fed in relation to machine travel
- Upper section is SELF-SUPPORTING
- Lower section is supported by a surface

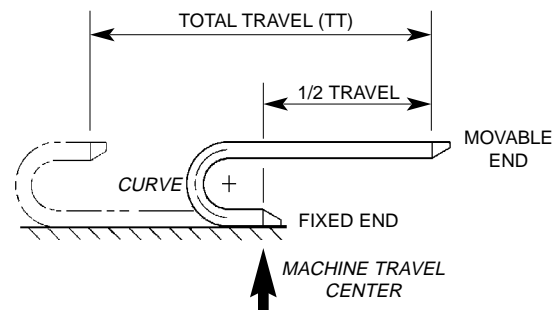

END FEED (One-Way Travel)

Applied where situation prohibits center-feeding of cables/hoses.

- ONE-WAY payout
- END-FED in relation to machine travel
- Upper section is SELF-SUPPORTING
- Lower section is supported by a surface

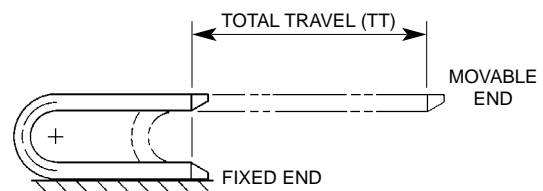

Model Number Explanation

	POWERTRAK TYPE	RADIUS (in.)	TOTAL LENGTH (ft.)
Example →	049P-2	1.1	3.4
Available types & sizes →	049P-1, 049P-2, 049P-3 071P-1, 071P-2	Refer to Catalog Pages	$\frac{TT}{2} + L$ or $TT + L$



Brake Products, Inc.

16751 Hilltop Park Place
Chagrin Falls, OH 44023
Phone: (888) 861-8777 • Fax: (440) 543-7963